

# Dimple Dash

20501 rA

Wall Sconce  
AC Input

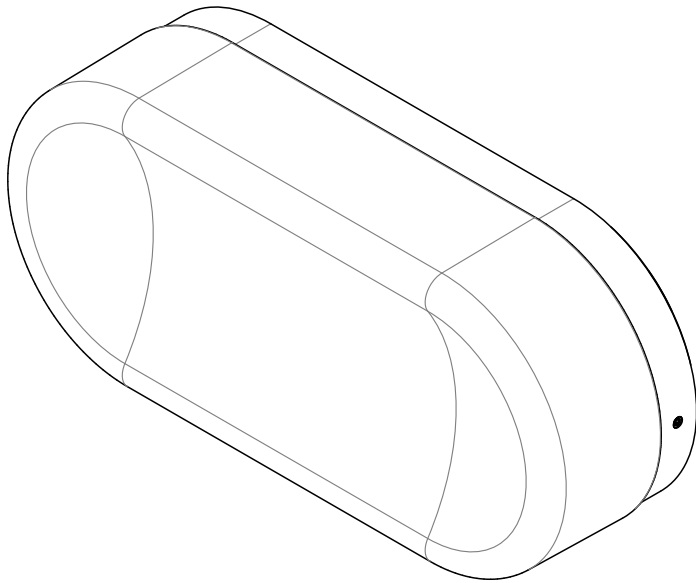

## CAUTION:

Before starting, turn off power  
at main circuit panel.

## ADVERTENCIA:

Antes de comenzar la instalación,  
apague la corriente en el tablero  
principal.

## ATTENTION:

Coupez l'alimentation avant de  
procéder à l'installation.



Calling for backup? Scan above  
to contact our team.

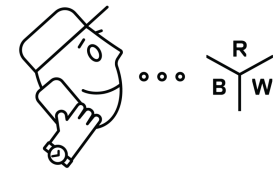
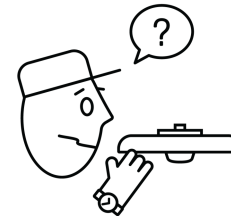

[www.RBW.com](http://www.RBW.com)  
+1 212 388 0399  
[support@RBW.com](mailto:support@RBW.com)  
© 2025, RBW Studio LLC

What's Included: Part Configurations May Vary

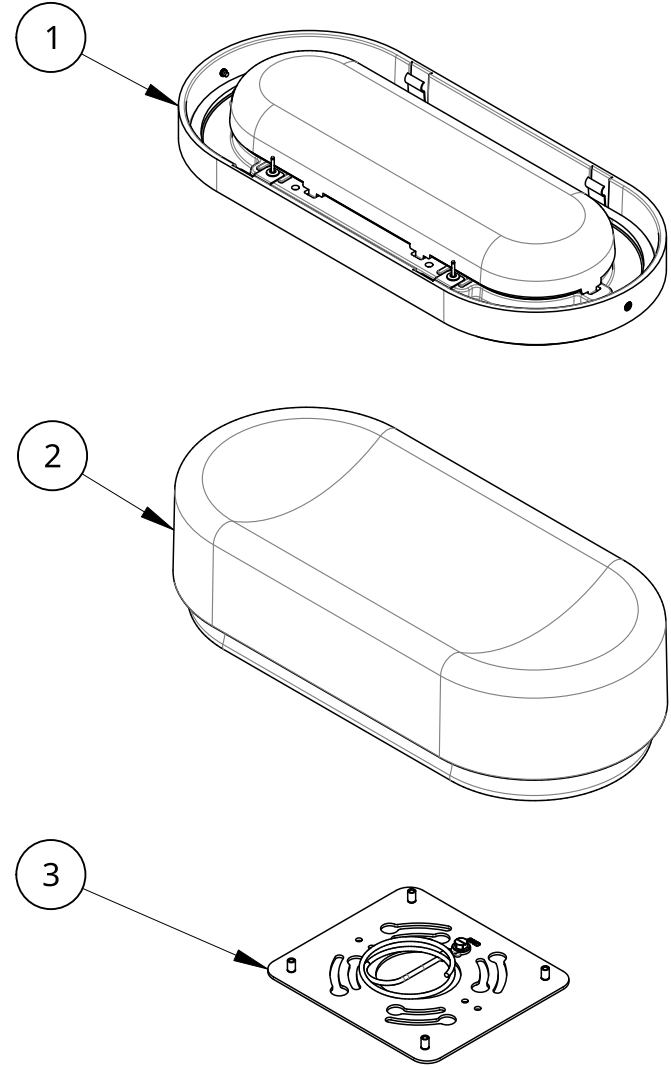

Item	Qty	Description
1	1	Assembly: Dimple Dash. Backplate
2	1	Dimple Dash. Glass Shade
3	1	Assembly: Dimple Dash. Wall Mount Plate w/ Mounting Screws

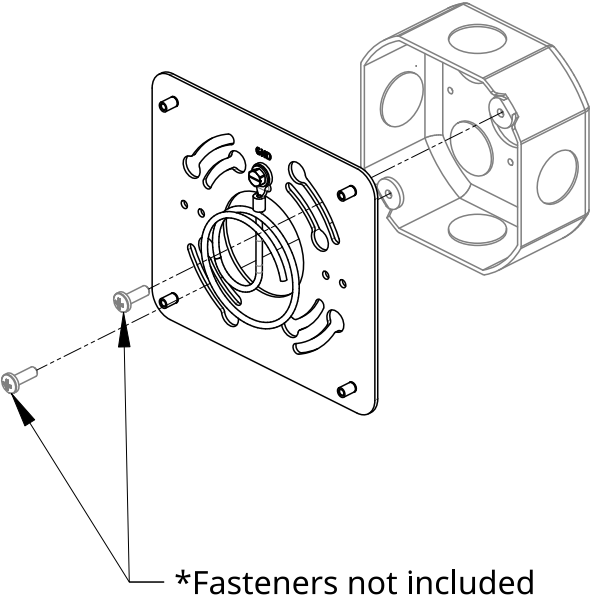

Installation - Wall Mount Plate

- 1. Connect Ground Strap according to electrical code.
- 2. Fasten Wall Mount Plate to Junction Box, ensuring edge of plate is level.

NOTE: This luminaire can be installed horizontally or vertically depending on the mounting orientation of the Wall Mount Plate.

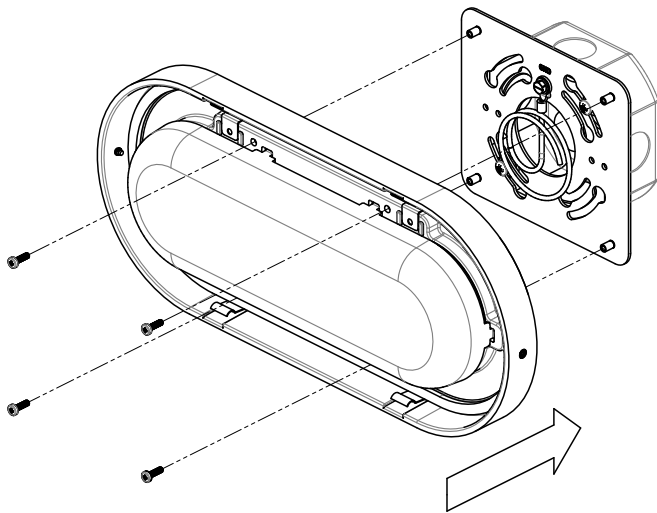

### Installation - Backplate

3. Connect Black (L) and White (N) Sconce wires to mains voltage power feed.
4. Fix Backplate to Wall Mount Plate with (4) provided fasteners.

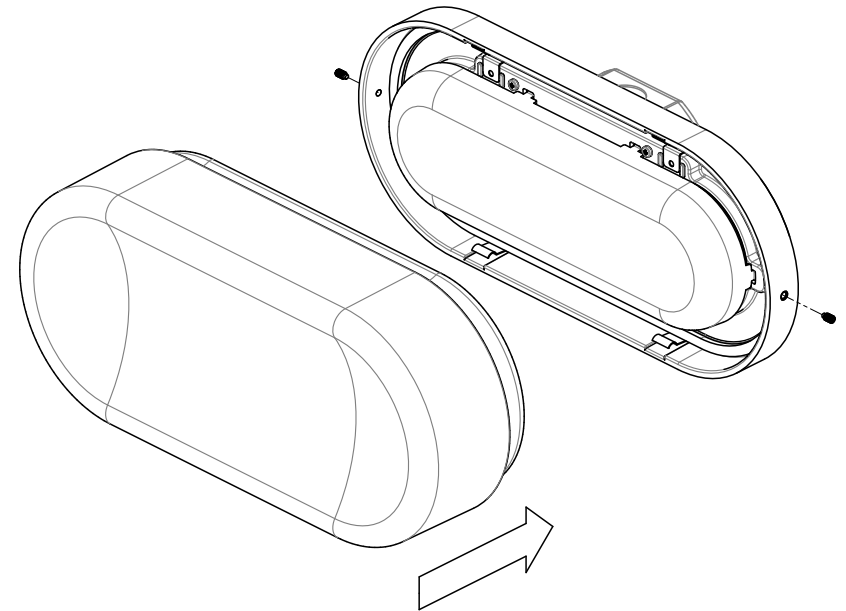

### Installation - Glass Shade

5. Snap Glass Shade into spring clips of Backplate, maintaining positive pressure on shade.
6. While pressing firmly on the Glass Shade to compress the inner gasket, tighten set screws at both ends of the Backplate to secure the glass.
7. Congratulations! End of guide.